



Plot 16, The Bradgate, Rose Place, Welshpool Road, Shrewsbury, SY3 5BU
£475,000



Plot 16, The Bradgate, Rose Place, Welshpool Road, Shrewsbury, SY3 5BU

£475,000

This spacious 4-bed Bradgate home is ideal for modern family living. On the ground floor, you'll love the open plan kitchen-diner with a glazed bay overlooking your East facing garden. The spacious lounge is perfect for relaxing with family. There's also a study, utility room and cloakroom. Upstairs are 4 great double bedrooms, the main with an en suite, and a stylish family bathroom. This home has a garage plus parking for 3 cars.

Description



null

Council Tax Band: TBC

Available:

EPC:

Floor Plans

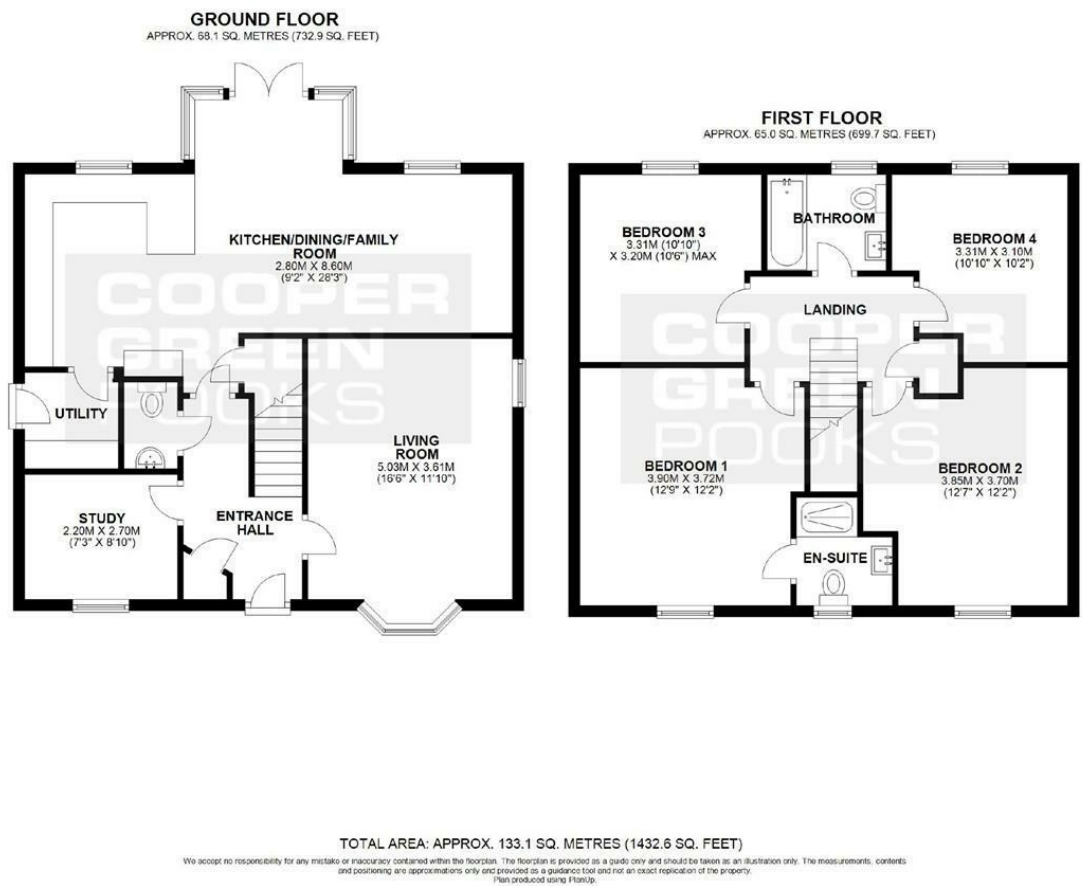

These particulars, whilst believed to be accurate are set out as a general outline only for guidance and do not constitute any part of an offer or contract. Intending purchasers should not rely on them as statements of representation of fact, but must satisfy themselves by inspection or otherwise as to their accuracy. No person in this firms employment has the authority to make or give any representation or warranty in respect of the property.